

# 101



**TUF GAMING**  
User Manual

TUF GAMING ALLIANCE







## Product Story

### ASUS TUF GAMING Alliance Design

To capture the vibes of the TUF GAMING motherboards, In Win and ASUS have united to design the 101 TUF GAMING chassis.

The exterior screams TUF, as the rugged steel enclosure is covered with a military design while donning the TUF GAMING Alliance emblem. Even the tempered glass side panel sports some war paint!



# Specifications

Model	101 TUF GAMING
Product Number	IW-101TUFGAMING
Color	Black
Case Type	Mid Tower
Material	SECC, ABS, PC, Tempered Glass
M/B Compatibility	12" x 10.5" ATX, Micro-ATX, Mini-ITX
Expansion Slots	PCI-E x 7
Maximum Compatibility	VGA Card Length : 421 mm (Maximum) VGA Card Length : 305 mm (With Side Radiator) CPU Heatsink Height : 160 mm
Front Ports	2 x USB 3.0 HD Audio
Internal Drive Bays	2 x 3.5" 2 x 2.5" (or 4 x 2.5 ")
Thermal Solution Compatibility	1 x 120 mm Rear Fan /120 mm Radiator 2 x 120 mm Side Fan / 240 mm Radiator 3 x 120 mm Bottom Fan / 360 mm Radiator
Power Supply Compatibility	PSII :ATX12V - Length up to 200 mm
Product Dimension (HxWxD)	445 x 220 x 480 mm (17.5" x 8.7" x 18.9")
Product Dimension (HxWxD) with screw & handle height	445 x 226 x 480 mm (17.5" x 8.7" x 18.9")
Package Dimension (HxWxD)	506 x 282 x 532mm (19.9" x 11.1" x 20.9")
Net Weight	7.85kg / 17.4lb
Gross Weight	9.15kg / 20.2lb

\* In Win products comply with RoHS regulation.  
\* Specifications may vary based on different regions.





## Case Structure



- 1 Power Button
- 2 Logo
- 3 HDD/Power LED Indicator
- 4 USB 3.0 Ports
- 5 Audio Ports (Earphone and Microphone)
- 6 2.5" Drive Bay
- 7 TUF GAMING Alliance RGB Panel
- 14 Power Supply Mounting Area



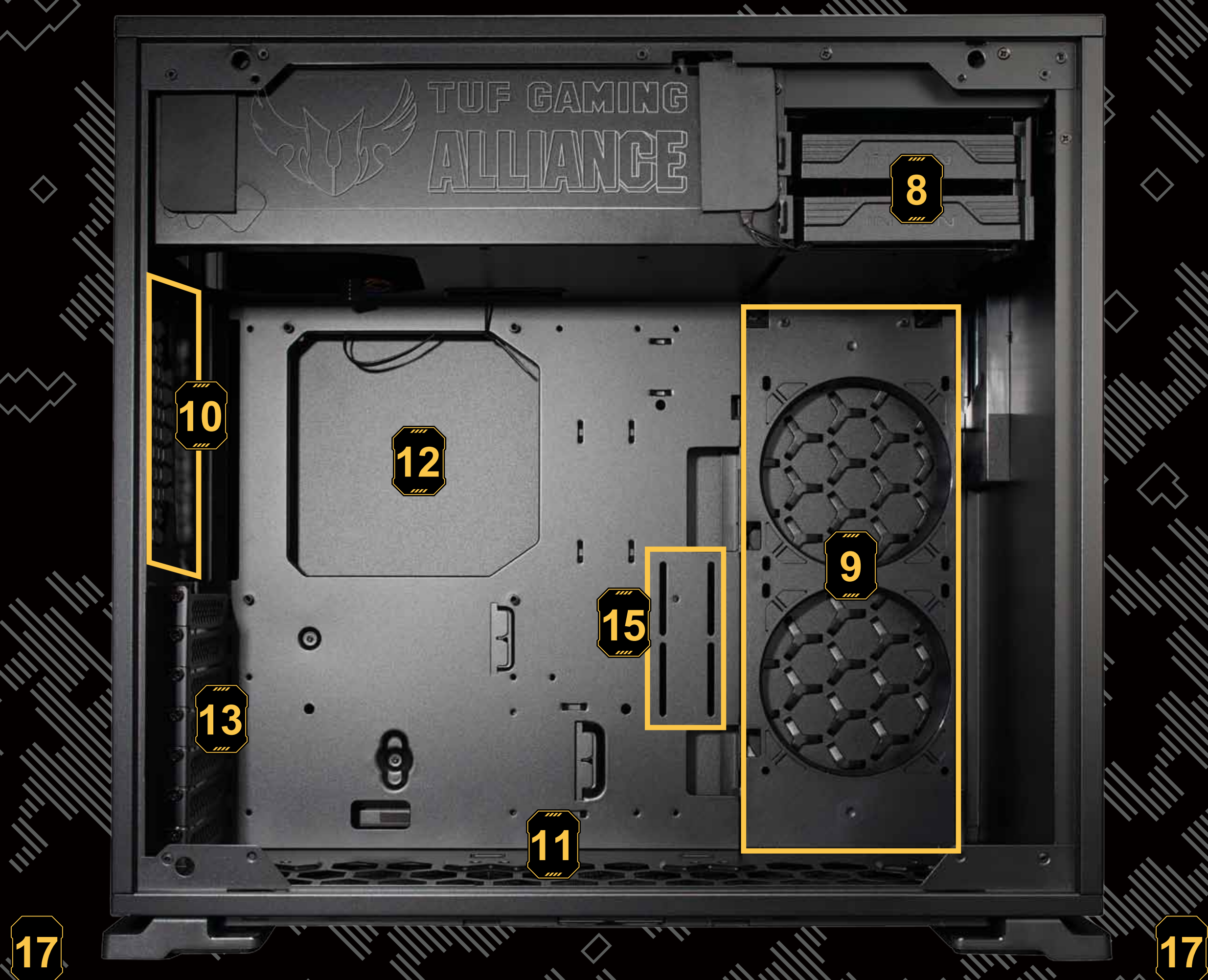

## Case Structure



- 8 3.5" /2.5" Drive Bay
- 9 Side Fan/ Radiator Mounting Area
- 10 Rear Fan/ Radiator Mounting Area
- 11 Bottom Mounting Area/ Radiator Mounting Area
- 12 Motherboard Mounting Area
- 13 PCI-E Expansion Slot
- 15 Extra PCI-E Supporting Mounting Hole
- 16 Fan Dust Filter
- 17 Shock-Proof Stand



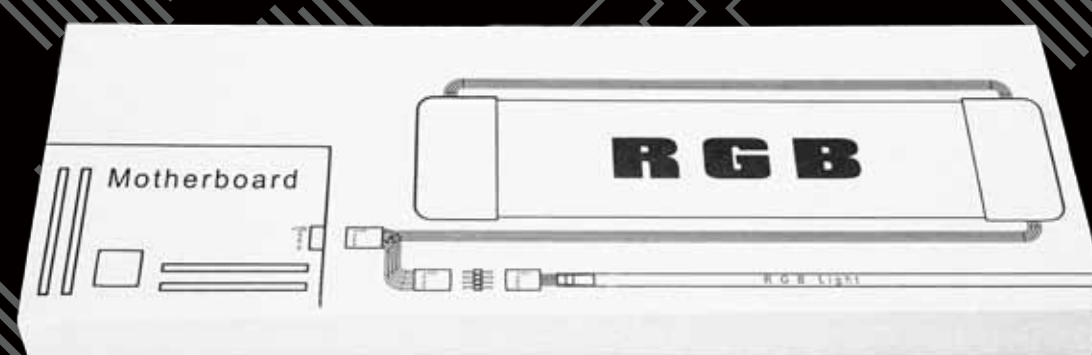

## Product content



- 1 101 TUF GAMING Chassis
- 2 QR Code Card
- 3 Accessories Bag
- 4 TUF GAMING Alliance RGB Panel



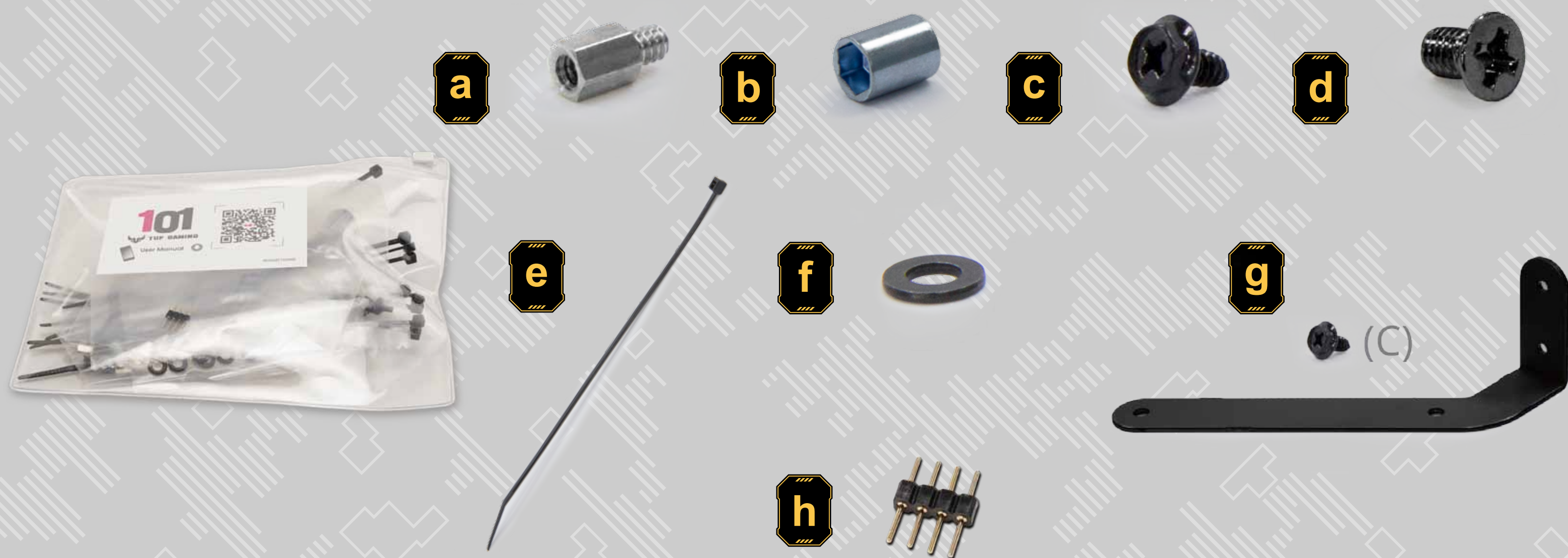

## Package Content



- a** Motherboard Stand-off x 7
- b** Motherboard Stand-off Socket x 1
- c** Hexagon Head Screws x 18
- d** 2.5" HDD Screws x 12
- e** Cable Tie x 10
- f** Water-cooling System Washers x 8
- g** Graphics Card Holder x 1
- h** RGB Pin Header x 1



## Installation Guide



### 1. Opening the Chassis

For the side panel, please pull the two toolless clips and lift up.

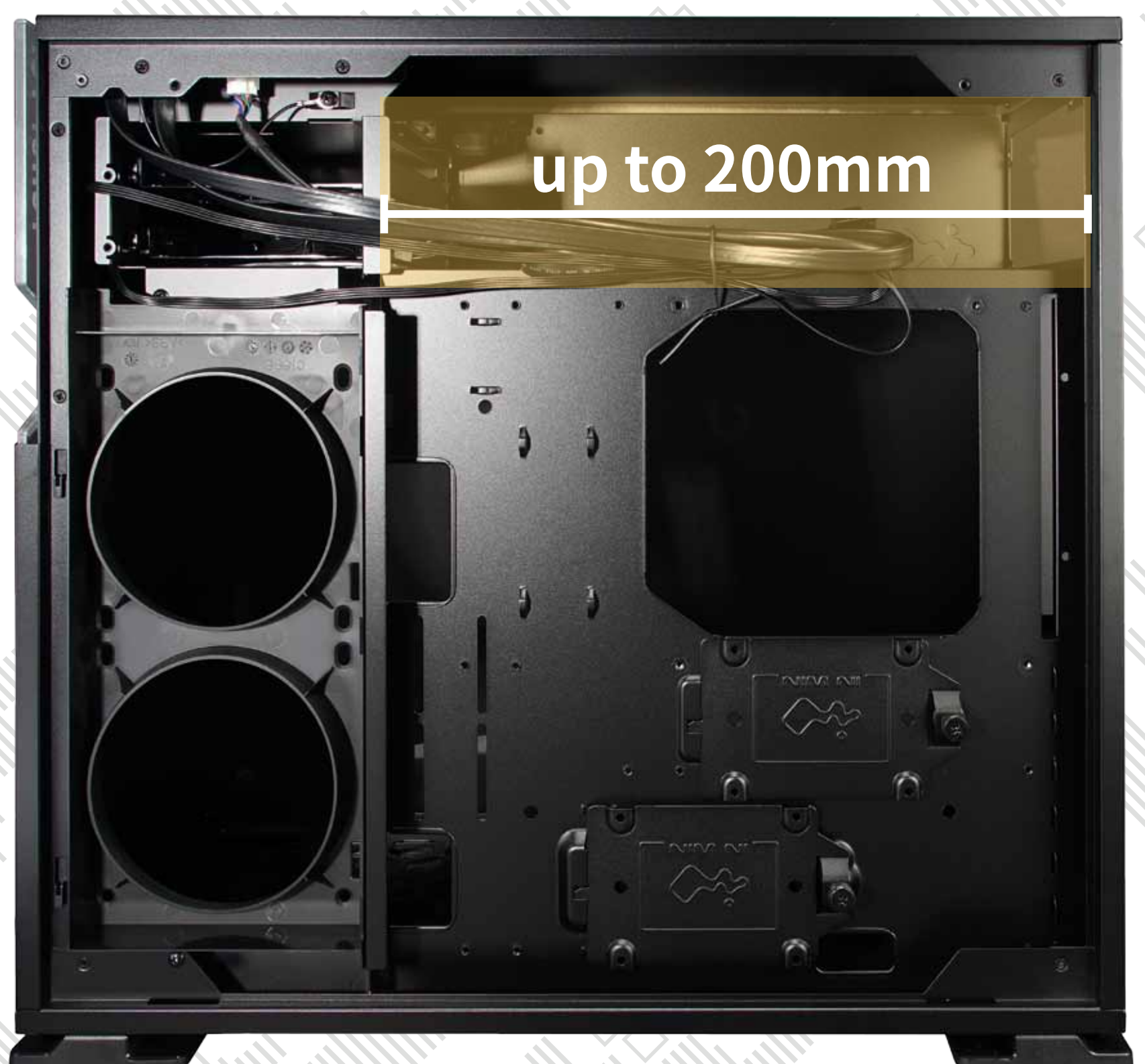

### 2. Power Supply Installation

Parts Required:  
Hexagon Head Screws.  
Power supply can be mounted on the top bracket.



### 3. Motherboard Installation

Parts Required:  
Motherboard Stand-Off,  
Motherboard Stand-Off  
Socket, Hexagon Head  
Screws.



## Installation Guide

### 4. Expansion Card Installation

Parts Required:  
Hexagon Head Screws,  
Graphics Card Holder.

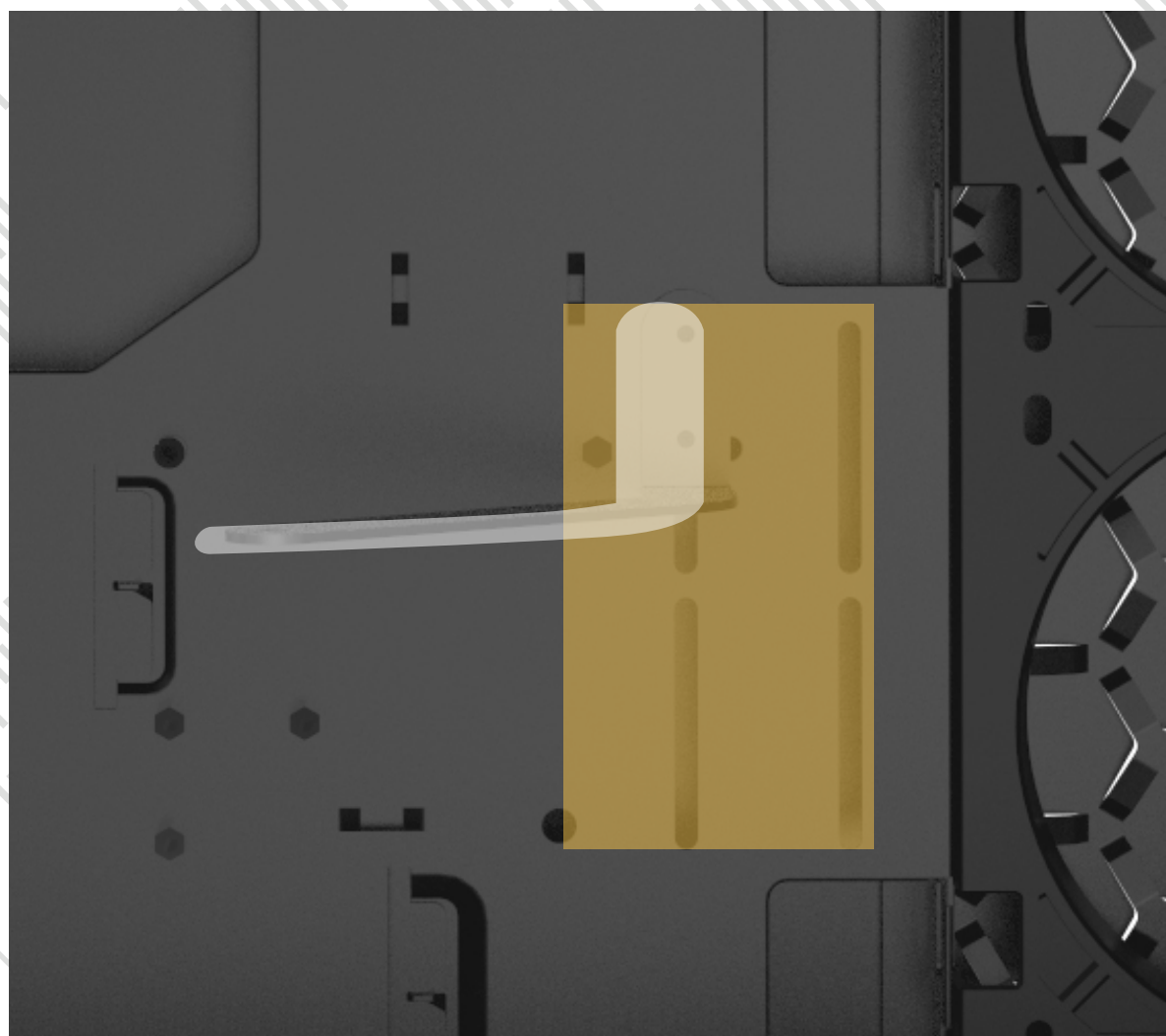



## Installation Guide

### 5.2.5"/ 3.5" Drive Bays Installation



## 6. RGB Panel Installation

Parts Required: RGB Panel

Please install the RGB panel on the top of the chassis, and then insert RGB-strip into the 4-pin RGB-strip header directly on the motherboard.





# Installation Guide

## 7. I/O Wires Installation

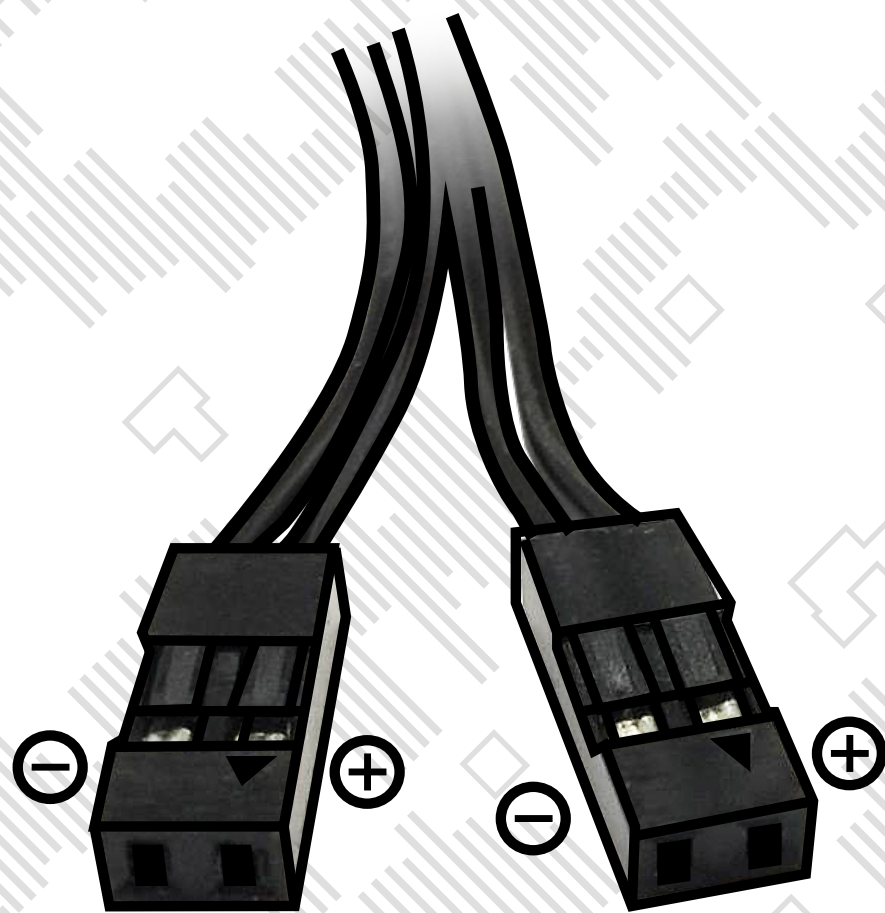

POWER SWH.D.D LED

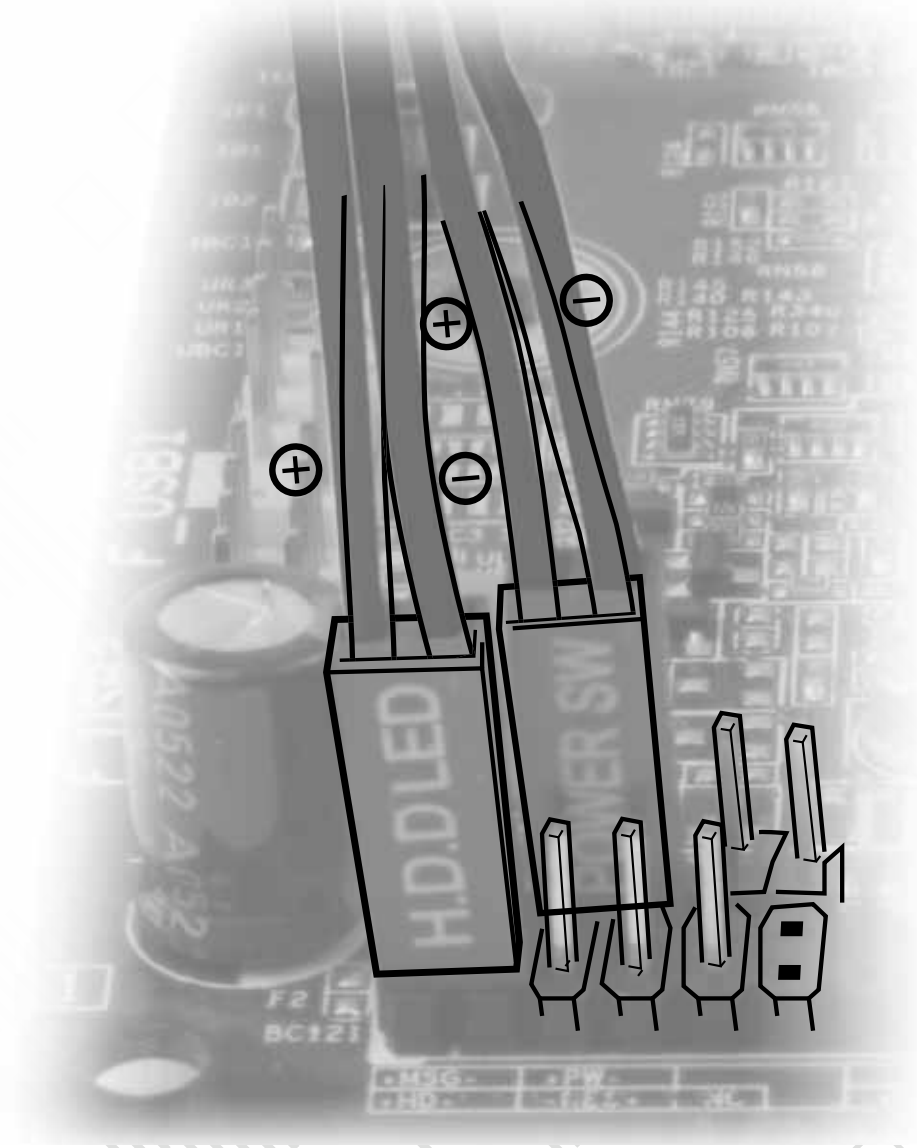

PORT2_2	Blue	10	9	Brown	SENCE2_R
SENSE_SEND	Purple	8	7		Key
PORT2_R	Yellow	6	5	Green	SENSE1_R
PORT1_R	White	4	3	Orange	PRESENCE#
PORT1_L	Red	2	1	Black	GND

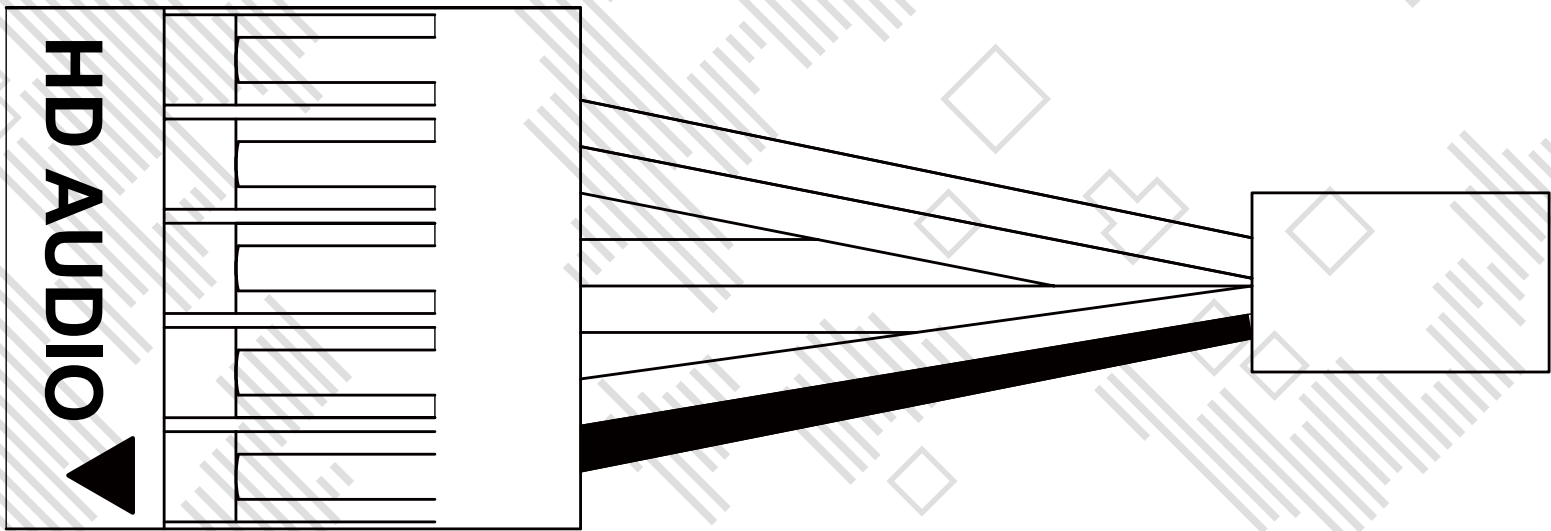

## USB3.0 Header

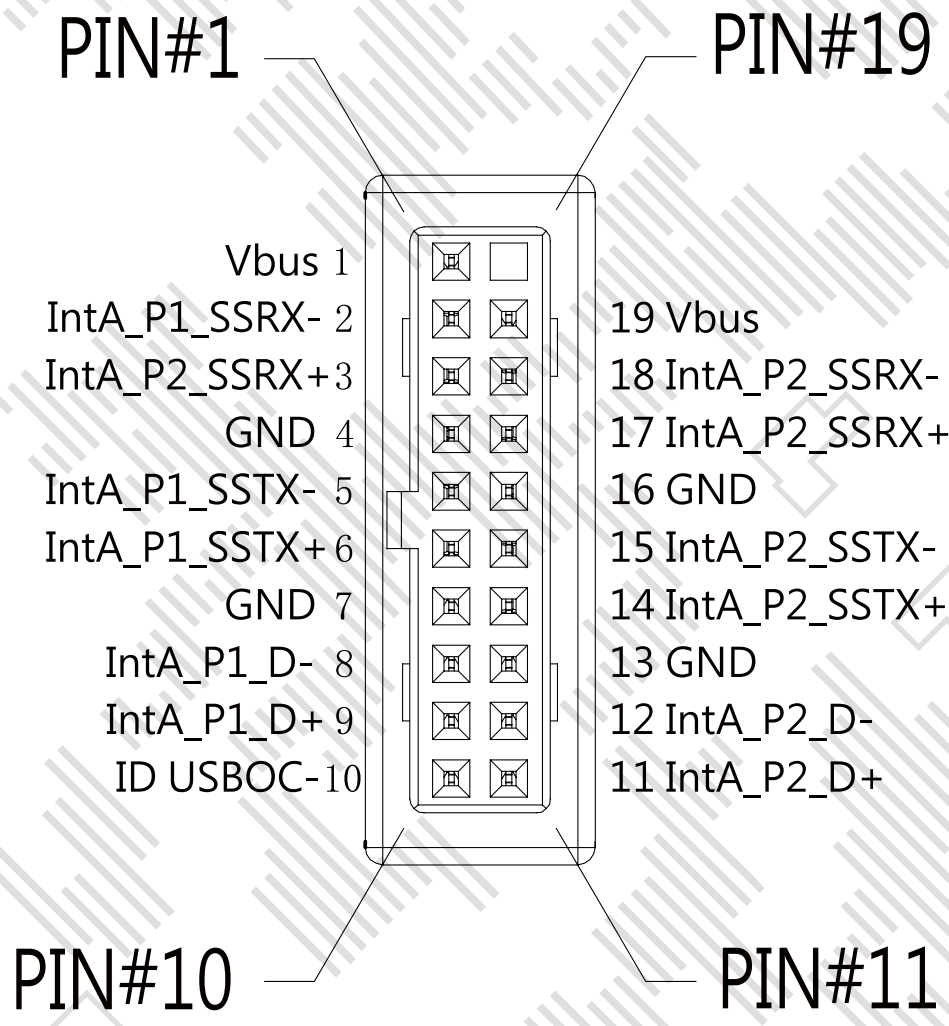
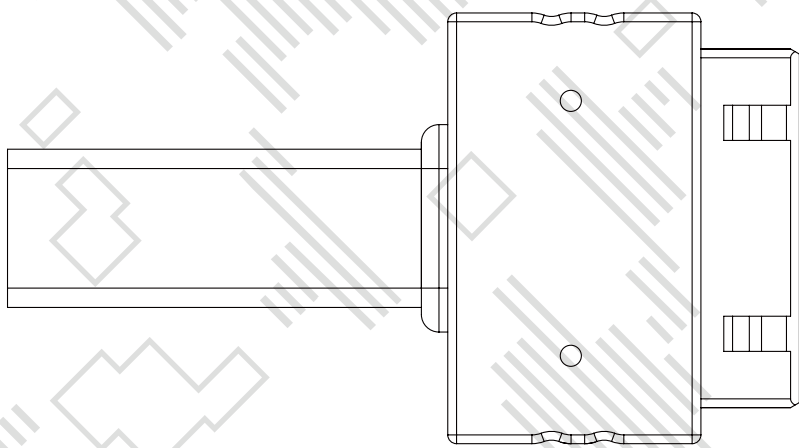



## Installation Guide

### 8. The instructions of RGB-Strip cable

If your motherboard support the RGB luminous effect, please follow the direction of sign and insert RGB-strip into the 4-pin RGB-strip header directly on the motherboard.

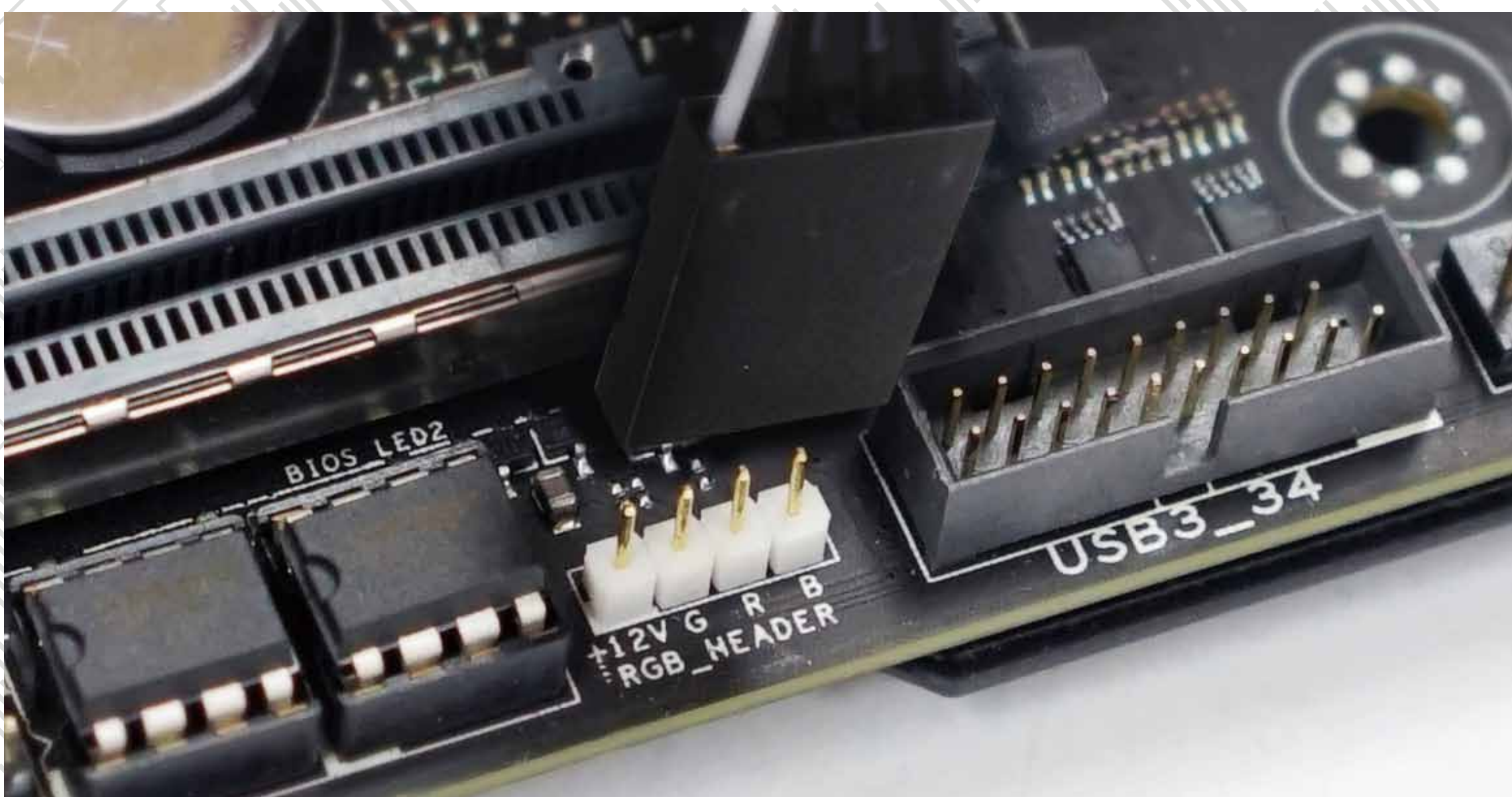
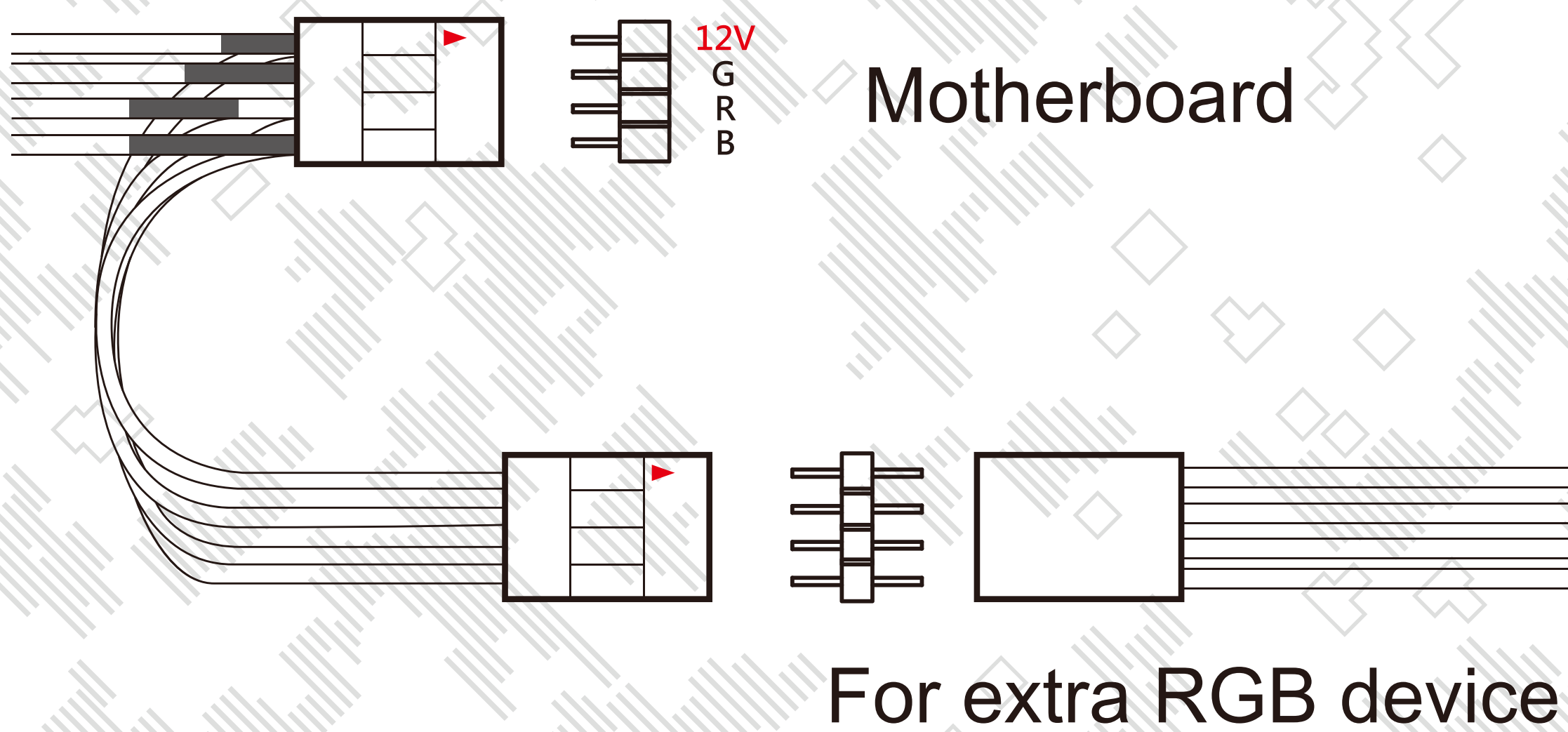
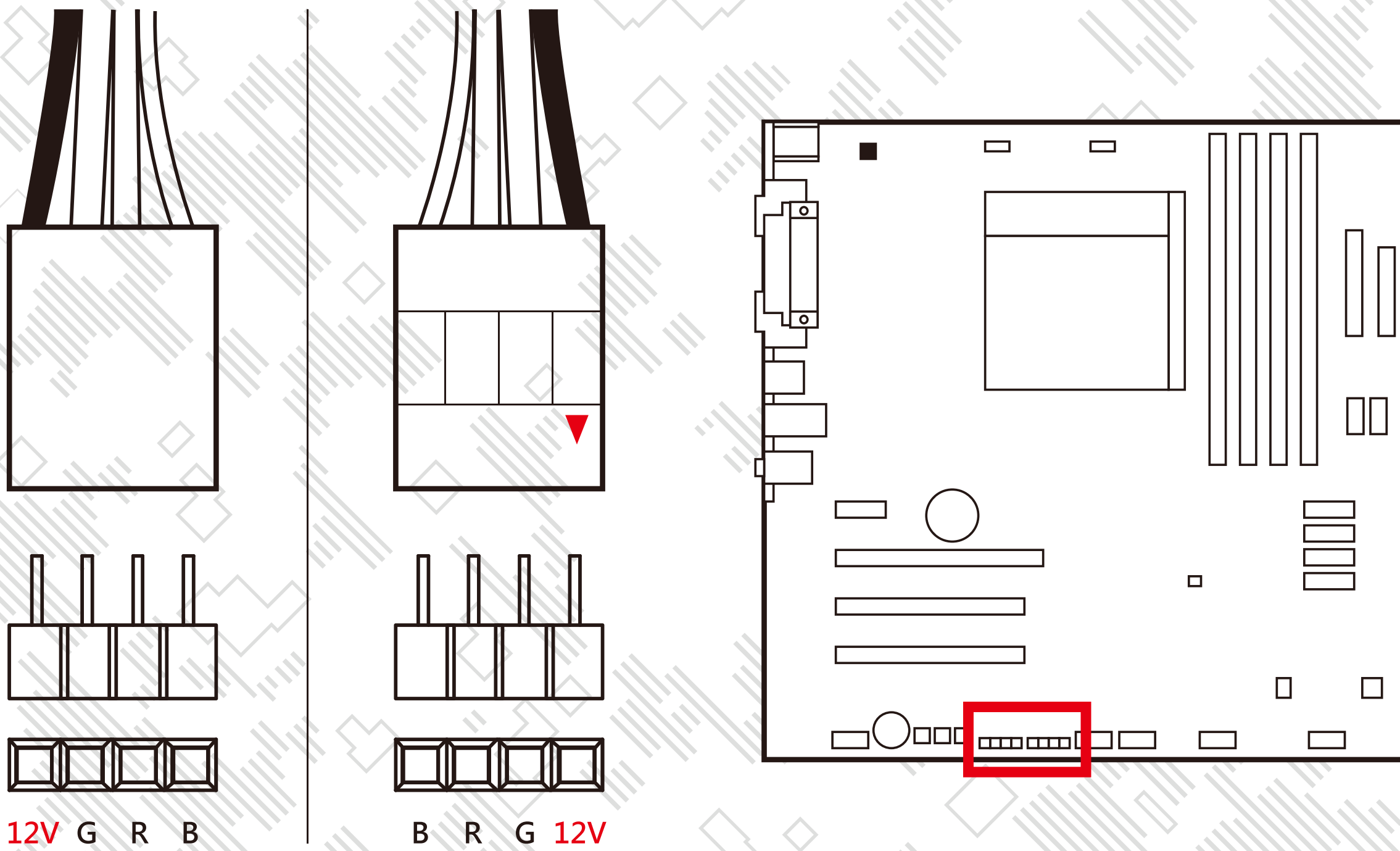



## Installation Guide

### 9. Fan / Liquid Cooling Radiator Installation

Parts Required: Water-cooling System Washer.



### 10. Completing Installation





### ◆ Notices

1. Please follow the user manual for installation.
2. When installing the computer components, please use the antistatic precautions to prevent ESD (electrostatic discharge) damage. This can cause injury to the installer and/or damage to the machine. Incorrect installation may burn motherboard and other system components.
3. To avoid any damages, please do not use this product for any other purpose than its intended use.
4. Any modifications may damage the product.
5. Please remove all internal devices before shipping or moving.  
(Including power supply, hard drive, CD-ROM, motherboard and CPU, etc)

### ◆ Warranty

- \* For more detailed warranty information, please visit In Win retail website at [www.in-win.com](http://www.in-win.com).
- \* The actual product is subject to change without prior notice. In Win Development Inc. reserves the right to make final modifications.



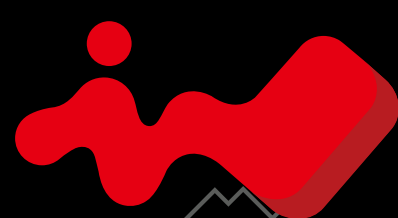

IN WIN

CONTEMPORARY & INNOVATIVE

www.in-win.com